

6224-2RS1 Deep groove ball bearings

- Popular item

Deep groove ball bearings

Bearing data

[Tolerances](#),

Normal (metric), P6, P5, Normal (inch),

[Radial internal clearance](#),

Matched bearing pairs, Stainless steel
d < 10 mm, Other bearings

Bearing interfaces

[Seat tolerances for standard conditions](#),

[Tolerances and resultant fits](#)

Technical specification

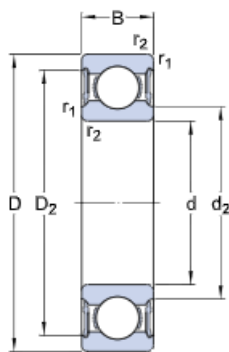

DIMENSIONS

d	120 mm	Bore diameter
D	215 mm	Outside diameter
B	40 mm	Width
d ₂	≈ 118.1 mm	Recess diameter
D ₂	≈ 189.2 mm	Recess diameter
r _{1,2}	min. 2.1 mm	Chamfer dimension

ABUTMENT DIMENSIONS

d _ε min.	132 mm	Diameter of shaft abutment
d _ε max.	150 mm	Diameter of shaft abutment
D _i max.	203 mm	Diameter of housing abutment
r _a max.	2 mm	Radius of shaft or housing fillet

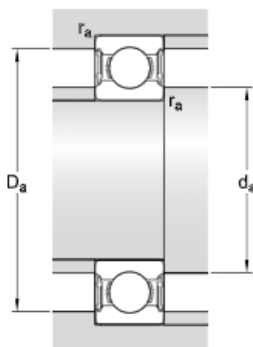

CALCULATION DATA

C	146 kN	Basic dynamic load rating
C ₀	118 kN	Basic static load rating
P _u	3.9 kN	Fatigue load limit
	1 900 r/min	Limiting speed
k _r	0.025	Minimum load factor
f ₀	14.4	Calculation factor

MASS

	5.36 kg	Mass bearing
--	---------	--------------

TOLERANCE CLASS

Normal	Dimensional tolerances
Normal	Radial run-out